

3-Jaw Pneumatic Chuck With Cylinder

- Featuring a built-in cylinder design, this setup is ideal for machining long pipes, such as threading oil pipeline tubes

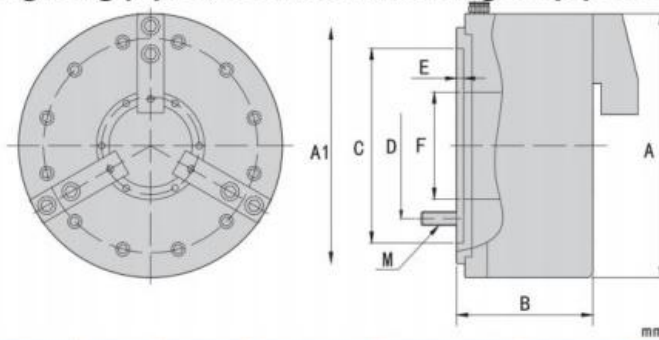

Model	A	A1	B	C(H6)	D	E	F	M
K53-350	380	315	192	235	275	7	115	6-M12
3KQ-400S	467	400	194	310	374	8	152	9-M12
K53-400			223				150	
K53-460			238				181	
K53-500	510		313 (338)	325 (300)	360 (330)	10.5	205	12-M16
K53-570	570	500	280	425	415	8	230	12-M12
K53-570A							280	
K53-600	605	535		450	450		280	
K53-630	685	610	305.5	510	510		325	
K53-730	730	658	301.5	560	560	10.5	355	
K53-850	850	775	352	700	700	8	375	12-M16
K53-900	900						440	
K53-1000	1000	850	330			10	560	
K53-1150	1050	1060	352	800	800		660	

Model	Single Jaw Stroke[mm]	Clamping Force(Air0.5Mpa) KN(kgf)	Max.speed [r.min]	Moment of inertial [kg.m ²]	Weight [kg]	Pressure Mpa(kgf/cm ²)
K53-350	13+7	62(6326)	3000	1.62	110	0.2-1(2-10)
3KQ-400S	7	130(13265)	1700	5.6	154	
K53-400	13+7		110(11220)	1300	6.5	
K53-460		140(14286)	9.8		190	
K53-500	17+7	160(16326)	1100	15.5	298	
K53-570	17+8.5	140(14286)	900	16.4	340	
K53-570A		180(18367)	750	16.1	325	
K53-600		190(19388)	800	19	360	
K53-630	15+10	200(20408)	700	28	520	
K53-730	13.4+12	190(19388)	450	44.2	583	
K53-850	15+10.4	200(20408)	750	71.2	970	
K53-900		190(19388)	700	105	980	
K53-1000	170(17347)	400	150	960		
K53-1150	230(23470)		194	1890		